



**NAPCO®**

333 Bayview Avenue

Amityville, New York 11701

For Sales and Repairs, (800) 645-9445

For Technical Service, (800) 645-9440

(Note: Technical Service is for alarm professionals only)

Publicly traded on NASDAQ Symbol: NSSC

© NAPCO 2010

# GEMC-24VR

## 24 Volt "Regulated" Output Module DATA SHEET

WI1915 09/10

### GENERAL DESCRIPTION

The GEMC-24VR "Regulated" Output Module is used with the Gemini C-Series control panel or the GEMC-NAC7L/S Supervised NAC Extender.

The GEMC-24VR is intended to provide a constant 24V regulated output (maximum current 1.0A) from the Gemini C-Series control panel motherboards or the GEMC-NAC7L/S Supervised NAC Extender. To provide this 24V regulated output, one of the four special application NAC outputs must be dedicated and programmed as "Reverse Polarity" and not programmed to activate on any alarms or events.

The GEMC-24VR must be used when the system requires a 24V regulated output for an initiating device rated for 24V. The GEMC-24VR module is required to

ensure that the voltage supplied to specific addressable SLC devices remains at or above 24 volts, even when the standby battery power drops to 20.4VDC when the battery is below 20.4DC (85% of nominal battery rating).

The GEMC-24VR device is a UL864 (9th edition) listed accessory to a Gemini C-Series control panel or GEMC-NAC7L/S Supervised NAC Extender.

The GEMC-24VR should be used when the following modules are used as part of the system:

- FWC-FSLC-DUCT
- FWC-FSLC-CZM
- FWC-FSLC-SOM1

### SPECIFICATIONS

#### Electrical Ratings

**Input Power:** 24V Unregulated, 2A maximum. Supplied from NAC output of the GEMC-Series motherboard or GEMC-NAC7L/S programmed for reversed polarity.

**Output Power:** 24V Regulated, 1.0A maximum (maximum is reduced by battery configuration and required standby time).

### PHYSICAL

**Dimensions:** W = 3.5", L = 4.32", H = 1.15"

### AGENCY LISTINGS

UL864 9th Edition: Commercial Fire

UL985: Household Fire Warning System Units

NFPA 72 National Fire Alarm Code

CSFM: California State Fire Marshall (Pending)

FM Approval: (Pending)

NYCFD: NYC Fire Department (Pending)

### ORDERING INFORMATION

**GEMC-24VR:** Commercial Fire 24V Regulated Output Module

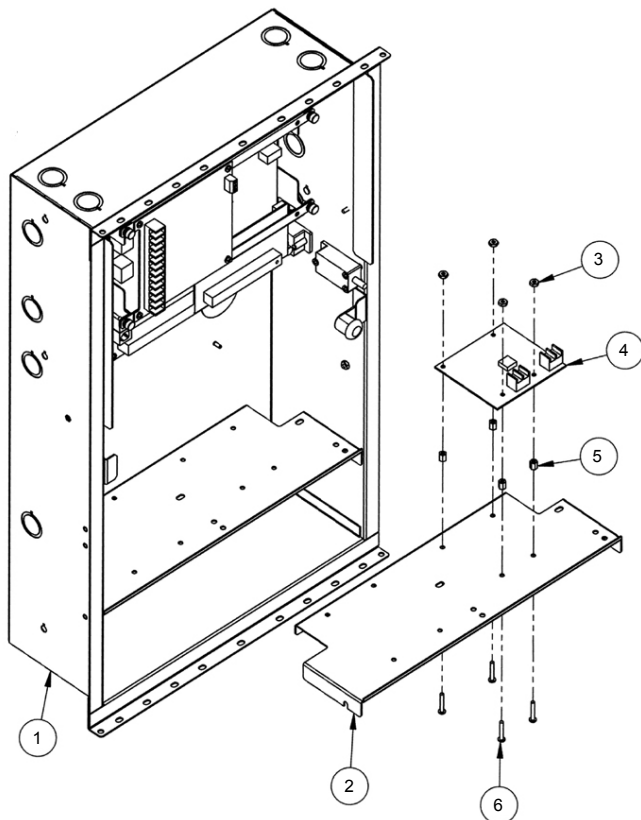

GEMC-24VR Installation Location (see part number table below)

Item	Part No.	Description	QTY
1	HW1688	Enclosure base	1
2	HW1489	Shelf	2
3	N101	6-32 kep nut	4
4	PCB	"Boost Buck" Circuit	1
5	SO216	Spacer, 1/4" x .313, 6-32 tapped	4
6	SC631	Screw 6-32 x 7/8 pph	4